



Datasheet

Submersible level transmitter

SUP-P260-M2

Supmea[®]

Committed to process automation solutions

Tel: 86-15158063876

E-mail: info@supmea.com

www.supmea.com

Datasheet

The submersible Level Transmitter is designed for difficult level sensing applications where sludge, slurry, or turbulence may be present. The transmitter provide continuous liquid level measurement by sensing the hydrostatic pressure produced by the height of liquid above the sensor and providing a 4-20 mA output signal compatible with PLC, panel meter, data logger, and other electronic equipment. The transmitter consists of a sensing element, encased in a 316 SS housing with cage and large diameter 316 SS diaphragm seal. The sensor prevents moisture intrusion, and performance well even when the assembly is buried in a layer of sludge or slurry.

Application

- Wastewater
- Wet Wells
- Oil tanks
- Sumps
- Reservoirs
- Sludge, slurry or turbulence
- Chemical storage tanks
- Lift station monitoring
- Liquid level in vented tank
- Landfill leachate monitoring
- Dewatering
- Pump control

Features

- Non-clogging and damage resistant to floating solids
- Durable 316 SS construction for reliable, long life in harsh environments
- 1/2 inch NPT threaded connection, allows the unit to be installed in a pipe/conduit
- Diaphragm is protected from physical damage and turbulence
- Added weight helps hold transmitter in place
- Excellent chemical compatibility for wide application use



Submersible level transmitter

Parameter
Relative pressure

bar	0...0.25	0...0.4	0...0.6	0...1	0...1.6	0...2.5	0...4	0...6	0...10
mH2O	0...2.5	0...4	0...6	0...10	0...16	0...25	0...40	0...60	0...100
psi	0...3.6	0...5.8	0...7.8	0...14.5	0...23.2	0...36.2	0...58	0...87	0...145

The given measuring ranges are also available in mbar, kPa and MPa.

Medium	Compatible liquids
Measure range	0m-0.5m-100m
Overload pressure	≤200%FS
Pressure type	G (surface pressure)
Accuracy	0.5%
Stability	±0.2%FS/Year
Zero temperature drift	±0.03%FS/°C
Sensitivity drift	±0.03%FS/°C
Temp compensation	0°C-50°C, -10°C-60°C
Medium temperature	-30°C-65°C
Power supply	12VDC-30VDC
Signal output	4mA-20mA,0V-5V(Customized)
Load Resistance	Current type: ≤ (U-12) /0.02(Ω)
Ingress protection	IP68

Electrical connection
Cable lengths

Meter (m)	1.5	3	5	10	15	20	25	30	40	50	60	80	100
Feet (ft)	5	10	20	30	40	50							

Other cable lengths on request

Wiring diagrams

2-wire-system (current)

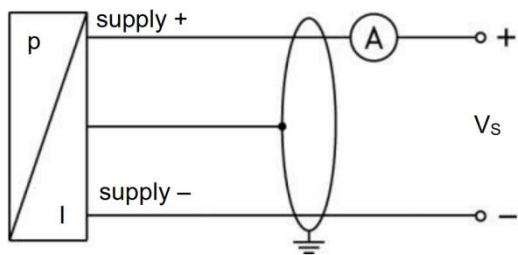

3-wire-system (voltage)

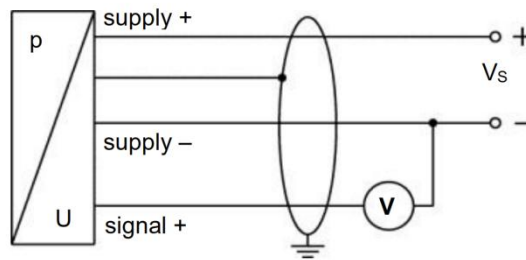

Current output:

- Red: 24V +
- Green: Current +
- Black: GND

Voltage output:

- Red: 24V +
- Green: 24V -
- Yellow: Voltage +
- Black: GND

RS485 output:

- Red: 24V +
- Green: 24V -
- Yellow: 485A
- Blue: 485B
- Black: GND

Dimension

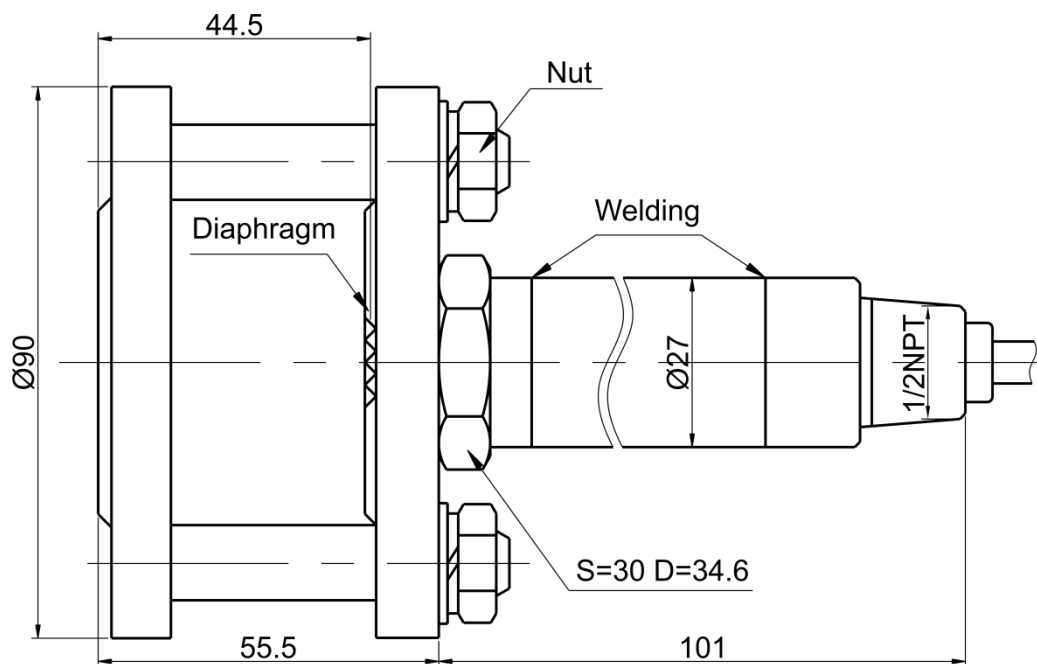

Ordering code

SUP-P260-M2-R(0-10)-J5-O0-D0-CS3-CT1-V1								Description
SUP-P260-	-	-	-	-	-	-	-	
M2								
Range	R(XX - XX)							0~0.5m...100m
Accuracy	J5							0.5%
Output			O0					/
			O1					4-20mA output
			O2					Customized
Communication				D0				/
				D1				RS485
Cable length					CS3			3m (Standard)
					CSXX			XXm
Cable material						CT1		PE
						CT2		PU
Power supply							V1	24VDC

Accessories

Data logger



Panel meter



Panel meter

